

**Winkley Elementary Drop-off and
Pick-up Locations**

Walkers/Bikers -Back

Buses

Car Riders

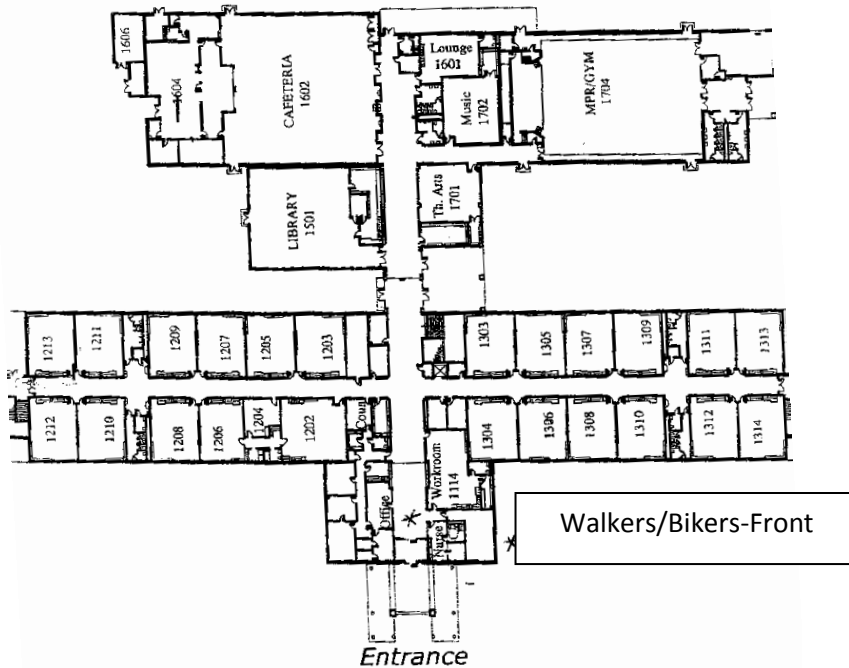

Students may be dropped off and picked up in four locations: buses, car riders, walkers/bikers in front and in back . All car riders will enter and exit through the MPR. During dismissal, students will wait in the MPR until they are called to the car rider location. Walkers/bikers in the back entrance group will enter and exit through the back door nearest to the cafeteria. Walkers/bikers in the front entrance group will enter and exit through the front door. Parents may wait under the front porch area for their students at dismissal. This front area is reserved for walkers and bikers and parents who are parking and conducting school business. This is not a drop-off area. Bus riders (including day care) will enter the North doors near the kindergarten classrooms.

*Students will be dismissed according to three bells:
2:40 bell-Car riders, 2:43-Buses/YMCA, 2:45-Walkers*